



**WINDOORS**  
INTERNATIONAL LTD.

Since  
1965

ISO 9001:2015; ISO 14001:2015 & ISO 45001:2018  
CBRI - 120 Mins Fire Rated in Metal and Wooden Doors  
PREFAB BUILDINGS + FIRE DOORS



**Labour Accommodation**

**Colony**

**Toilet**

**Store**



# WINDOORS INTERNATIONAL LTD.

Since 1965

ISO 9001:2015; ISO 14001:2015 & ISO 45001:2018  
CBRI - 120 Mins Fire Rated in Metal and Wooden Doors  
PREFAB BUILDINGS + FIRE DOORS

Since 1965 we have strived for excellence and highest quality.

At Windoors International Limited, we have gone over and above to meet the highest standards expected by the market. Our Journey shows that despite the humblest of beginnings we always aim to strive for more



**115000+**  
NUMBER OF  
PRODUCTS SOLD



**59+**  
YEARS OF  
EXPERIENCE



**150+**  
FAMILY  
STRENGTH



**1350+**  
SATISFIED  
CLIENTS

## CERTIFICATES



ISO 9001:2015 Certification



ISO 14001:2015 Certification



ISO 45001:2018 Certification



IGBC Membership



CRISIL SE-1A Rating



MSME Certification





# LABOUR ACCOMMODATION

One of the biggest benefit of labour colony, is that it provides a living space for workers close to the construction site, this saves a lot of time from transporting the workers to and fro from their accommodation. This time saved can be dedicated to the construction activities, increasing the efficiency of the project.

Clients who have been making our journey special



and many more...



# 3D STRUCTURAL MODEL

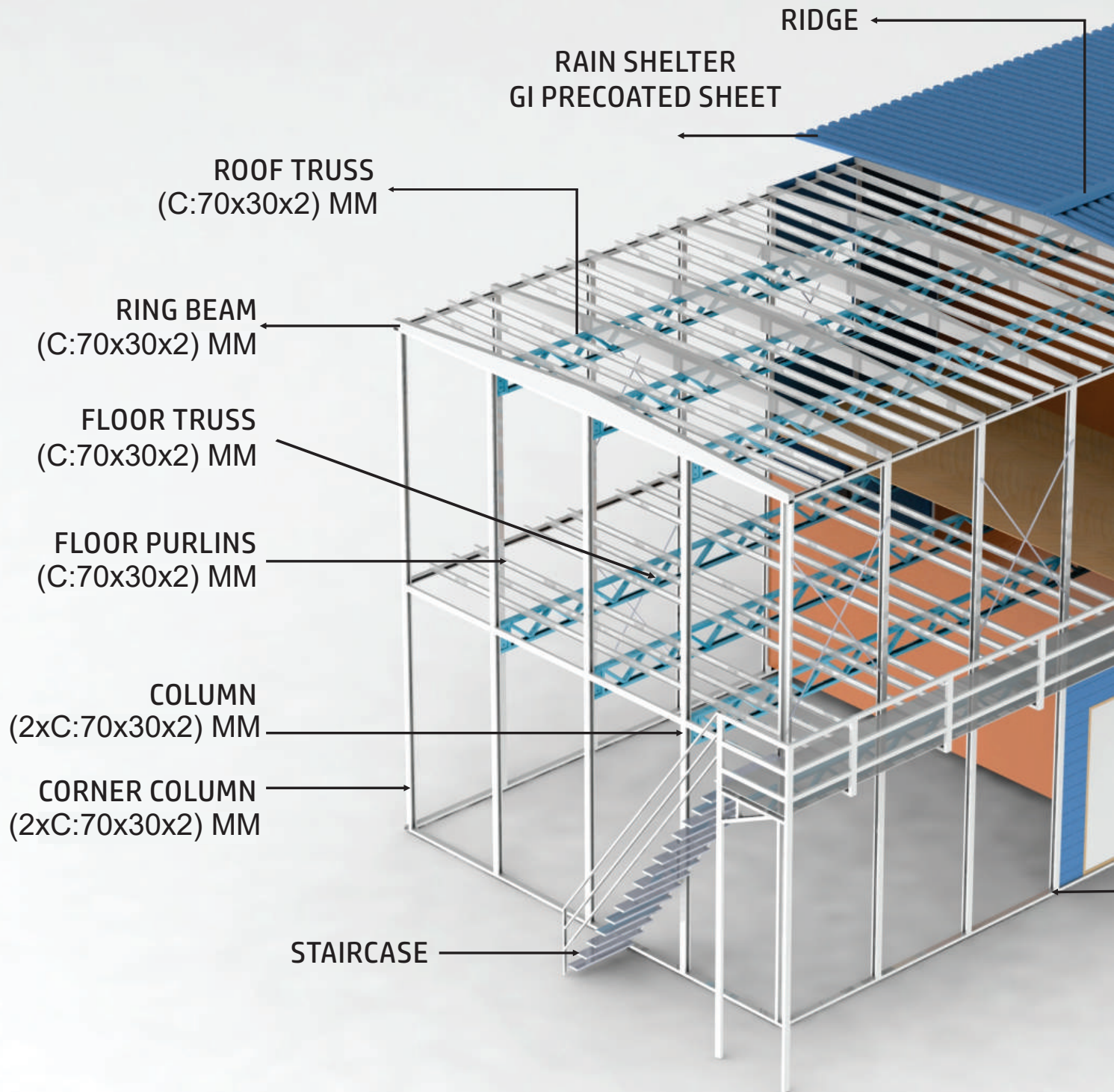

## INSTALLATION PROCESS



Prefabricated with Precise Engineering Dispatched and now ready for assembly.

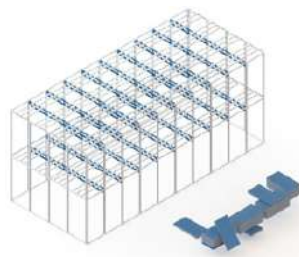

With Our Professional Team Assembling Structural Framework.

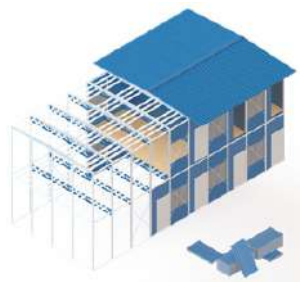

Followed By The Installation Of Panels And Flooring.

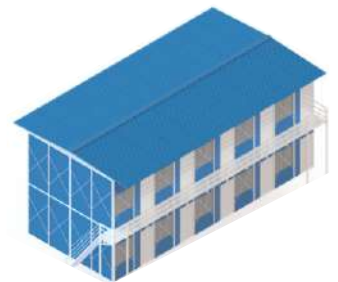

And With The Final Electricals And Staircase Installation, The Structure is Ready to Use.

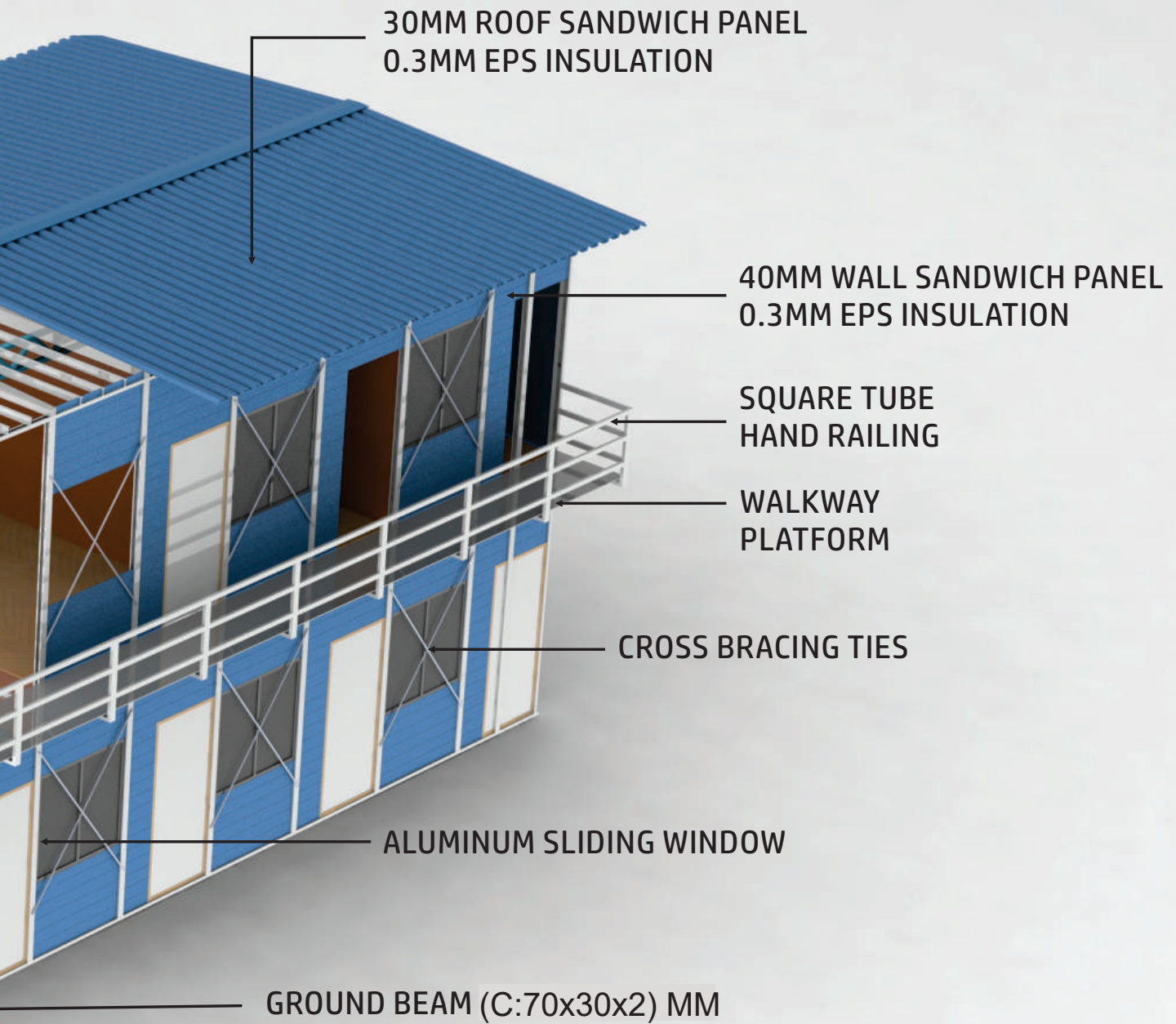

## DESIGN PARAMETERS

Roof Dead Load

**30**  
kg/m<sup>2</sup>

Roof Live Load

**50**  
kg/m<sup>2</sup>

Floor Dead Load

**50**  
kg/m<sup>2</sup>

Floor Live Load

**230**  
kg/m<sup>2</sup>

Wind Speed Upto  
(As Per Indian Condition)

**140**  
km/hr





# TECHNICAL SPECIFICATIONS

**Windoors International Limited** is India's Largest manufacturer of Portable Cabins and Labour Accommodation, made with cutting edge technology, we bring unparalleled energy efficiency, long-lasting reliability.

## SPECIFICATIONS

**Side Wall:** Wall Panels of Pre-Coated Galvanized sheet of 0.3mm both inside & outside with EPS as insulation to form wall thickness of 50mm

**Roofing:** Roof made of Pre-Coated Galvanized 0.3mm both inside & outside with EPS as insulation to form wall thickness of 30mm.

**Main Structure Pillars & Columns:** Structure of 2mm double 'C' shaped (70x30x8mm) galvanized channels.

**Flooring For First Floor:** Structure made of 2mm double 'C' Shaped (70x30x8mm) Galvanized Channels with 16mm Cement Bonded Fiber Board.

**Bracing (tie) Walls:** 8mm M.S.Rods In 'X' Shape.

**Partition Wall:** 0.3mm Pre-coated specially corrugated galvanized sheet.

**Staircase:** Structure of M.S. hollow pipes with 3 mm chequered plate & M.S. railing of 870mm width.

**Doors:** Pre-Coated Insulated Door of 32mm with fittings like Aldrop, Handles.

**Windows:** 2 Track Aluminium Powder Coated with 4mm Plain Glass.

**Electricals:** Fire Retardant Grade of Electrical Fitting Like Fans, Tubelights, Necessary Switch and Sockets will be Provided. (In Each Room Electrical Fittings which Includes Ceiling Fans) 2NOS, Tubelight -2Nos, 5AMP Switch Socket -2NOS & MCB -1NOS



Highly Durable



Easy Assembling



Movable Structures



Market Leader & Innovative



57 Plus Years of Experience



Unparalleled Quality



# LABOUR TOILET

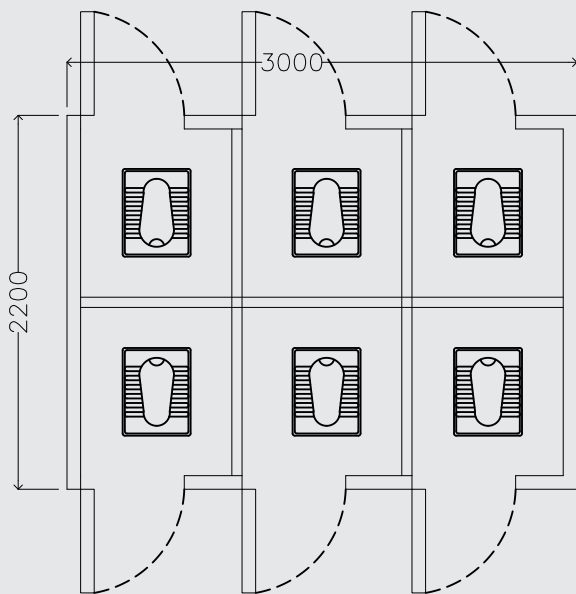

## SPECIFICATIONS

**Bottom Frame :** 100mm Specially Formed Galvanized Channel

**Top Frame:** 60 x 40mm M.S. Rectangular Hollow Pipe

**Stiffeners Bottom:** Combination of M.S Hollow pipes and formed Galvanized Channels

**Stiffeners Top:** M.S Hollow pipes

**Side Post:** 40 x 40mm M.S. Square Hollow Pipe

**Wall Panels:** 0.3mm Precoated Galvanized Sandwich Panels Insulated with E.P.S.

**Roof Outside:** 0.3mm Precoated Galvanized Sandwich Panels Insulated with E.P.S.

**Bottom Flooring:** 16mm Cement Fibre Board with 1.2mm Vinyl Carpet

**Door:** 0.3mm Precoated Galvanized Sandwich Panels Insulated with E.P.S.

**Insulation:** E.P.S. Insulation

**Wiring:** PVC insulated copper wire (FR grade)

**Electrical Fittings:** (i) MCB (ii) Bulb

**Earthing:** Earthing Point shall be provided for SAFETY

**Legs:** Legs at all four corners

**Hooks:** Specially formed Hooks for Easy lifting and Shifting





# WINDOORS INTERNATIONAL LTD.

ISO 9001:2015; ISO 14001:2015 & ISO 45001:2018  
CBRI - 120 Mins Fire Rated in Metal and Wooden Doors  
PREFAB BUILDINGS + FIRE DOORS

Since  
1965



For Website



For Whatsapp

#### Office:

115, New Tejpal Estate, Andheri-Kurla Road, Sakinaka, Mumbai - 400 072.

#### Manufacturing Plant:

Survey No. 16/1, 16/3, & 12/8, Near Paramount Hotel, Nashik Road (NH3), Kasane Village, Thane - 421 302

Phone No: +91 9820920678 / +91 9819346561 / +91 9820927229

Email ID: [yash@windoors-india.com](mailto:yash@windoors-india.com)

Website: Prefab Buildings - [www.windoors-india.com](http://www.windoors-india.com)

Fire Doors - [www.windoorsltd.com](http://www.windoorsltd.com)